

SITE PLAN KEYNOTES

1	ADA SITE ACCESS PATH OF TRAVEL.
2	EXISTING ASPHALT PAVING TO REMAIN.
3	PROPOSED CONVENIENCE STORE IN EXISTING SPACE.
4	EXISTING PLANTER TO REMAIN.
5	EXISTING 9' X 18' STANDARD PARKING SPACES TO REMAIN.
6	EXISTING CONCRETE SIDEWALK TO REMAIN.
7	EXISTING TRASH ENCLOSURE TO REMAIN.
8	EXISTING HANDICAP ACCESSIBLE PARKING TO REMAIN.
9	EXISTING PARALLEL PARKING SPACES TO REMAIN.
10	EXISTING SPEED BUMP TO REMAIN.
11	EXISTING BUS STOP BENCH TO REMAIN.
12	EXISTING FIRE HYDRANT TO REMAIN.

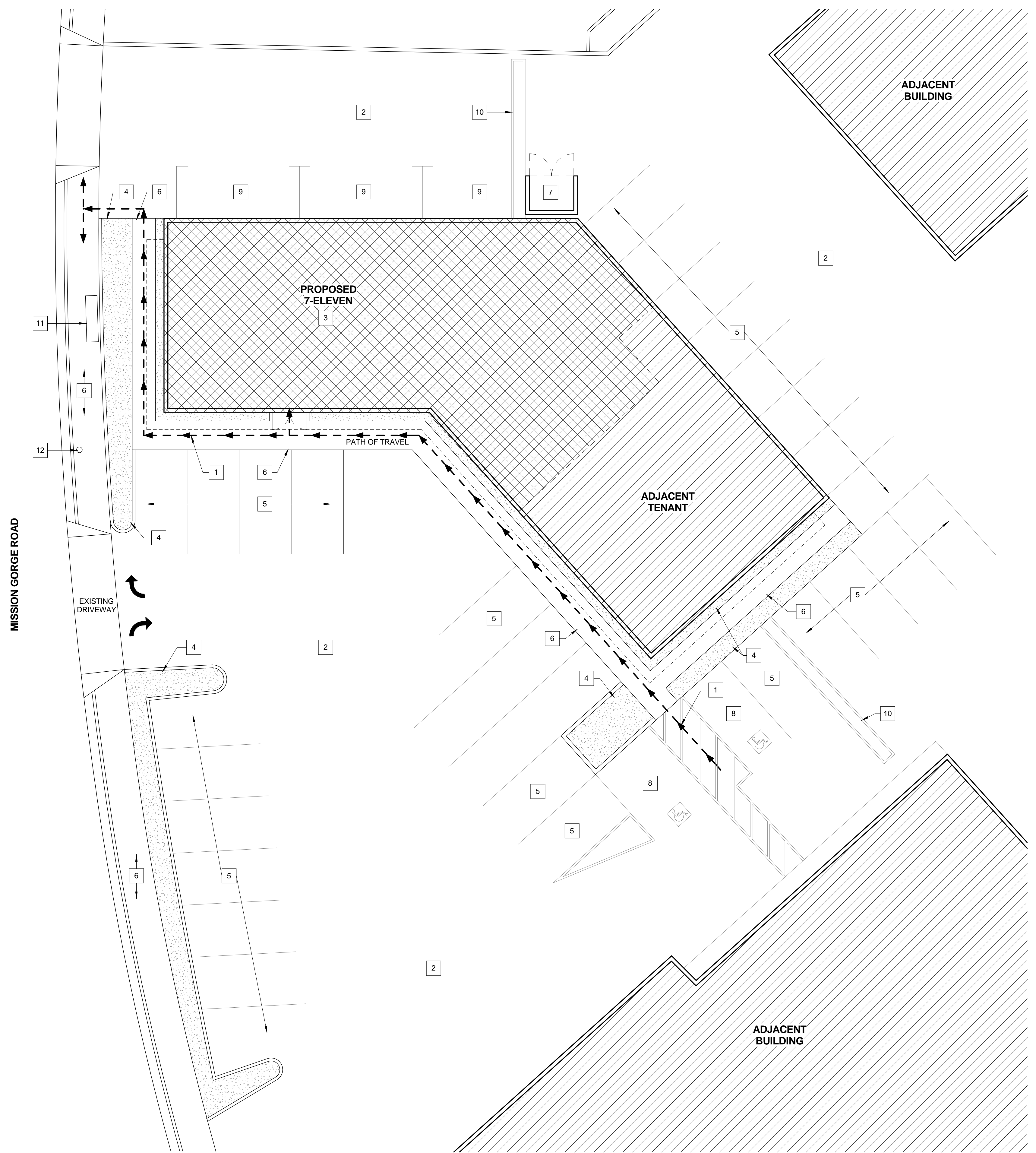

1
SITE PLAN
 1" = 10'-0"

STIPULATION FOR REUSE
THIS DRAWING WAS PREPARED FOR THE USE OF THE PROJECT IDENTIFIED HEREIN AND IS NOT TO BE REUSED FOR ANY OTHER PROJECT WITHOUT THE WRITTEN PERMISSION OF HFA ARCHITECTS ENGINEERS INTERIORS. ANY REUSE OF THIS DRAWING FOR ANY OTHER PROJECT WITHOUT THE WRITTEN PERMISSION OF HFA ARCHITECTS ENGINEERS INTERIORS IS UNAUTHORIZED AND MAY BE CONSIDERED AS A VIOLATION OF THE PROFESSIONAL ETHICS OF THE ARCHITECTURAL AND ENGINEERING PROFESSIONS.



7-ELEVEN
&
MISSION GORGE RD. &
FAIRMOUNT AVE.
SAN DIEGO, CA
JOB NUMBER: 12-12-00675

ISSUE BLOCK

STORE NO.: 36751
DOCUMENT DATE: 1/14/13
CHECKED BY: C S
DRAWN BY: LS

SITE PLAN

SHEET:
A101